

TECNOCAT **WORK SERIES**

VP-GB8 | VP-GB8+8 | VP-GB8.4 | VP-GB8.4+8

VP-GB8 | VP-GB8+8 | VP-GB8.4 | VP-GB8.4+8

WORK SERIES

VP-GB8.4+8

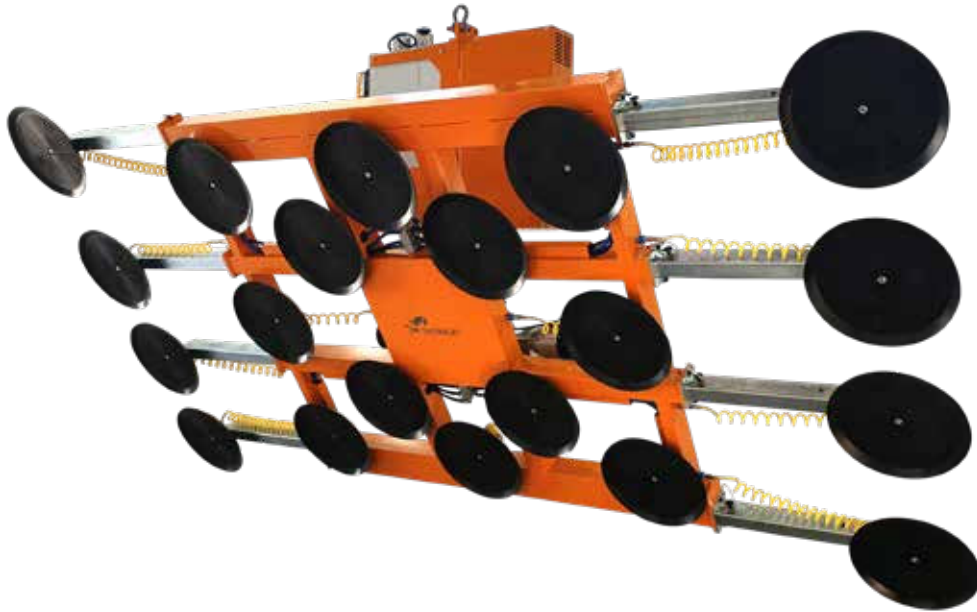

WORK SERIES

VP-GB8

 1000 kg
 402 kg

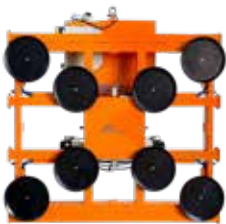

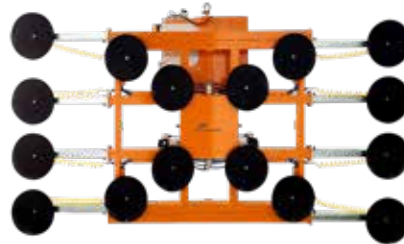

VP-GB8+8

 2000 kg
 530 kg





VP-GB8.4

 1500 kg
 425 kg



VP-GB8.4+8

 2500 kg
 553 kg

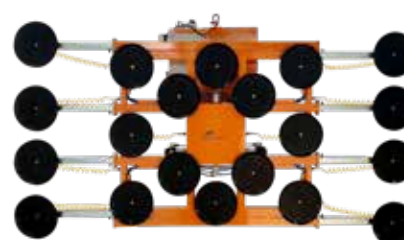

EN-15155	OK
kW	950 W
⌚	0° - 360° Endless
📏	3 m
📶	OK

🔌	200 - 500 VAC (50 - 60 Hz) + 24 VDC
🚰	166 L/min
📐	0° - 90°
🔋	OK - Running period 12h aprox
🛠️	OK

VP-GB8.4+8

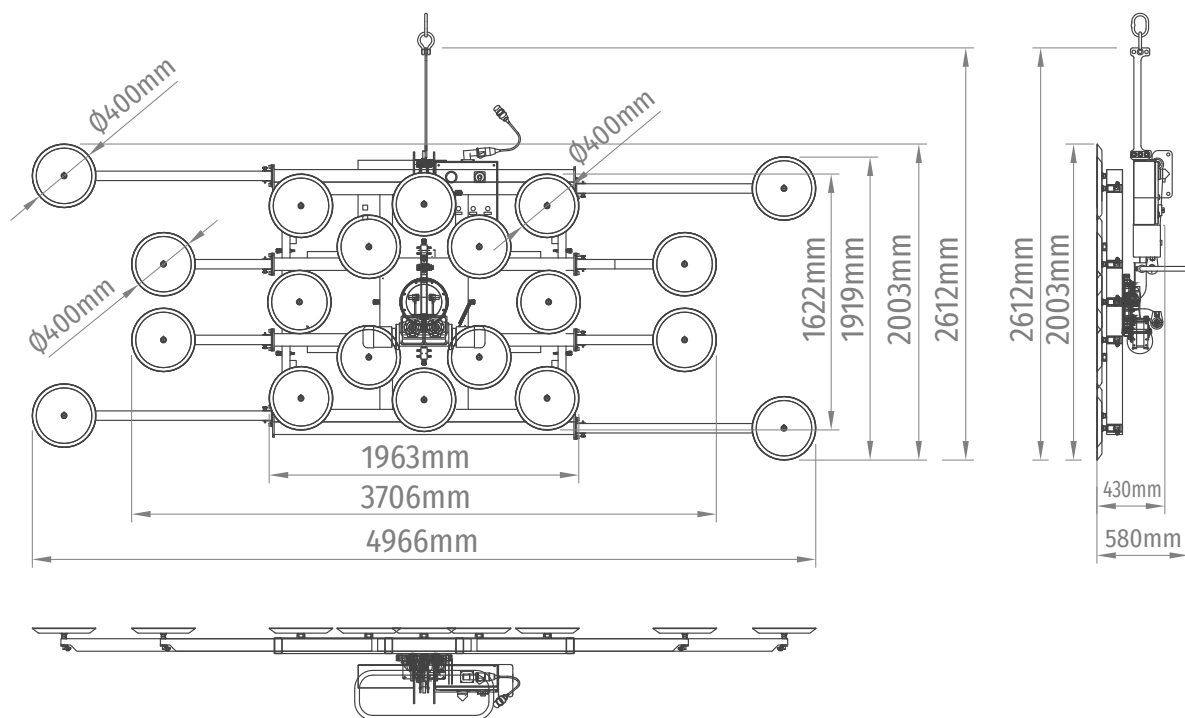

WORK SERIES

VP-GB8



VP-GB8+8



VP-GB8.4



VP-GB8.4+8



INCLUDED

- M-BOX METAL BOX
- MI-100 WIRELESS PUSHBUTTON CONTROLLER

PICTOGRAMS



ELECTRICAL POWER



MANUAL ROTATION EQUIPMENT



NOMINAL ELECTRIC POWER



PNEUMATIC ROTATION EQUIPMENT



ENERGY AUTONOMY BY BATTERIES



MOTORIZED ROTATION EQUIPMENT



PNEUMATIC SUPPLY



HYDRAULIC ROTATION EQUIPMENT



MAXIMUM LOAD CAPACITY



EQUIPMENT WEIGHT



MAXIMUM LOAD CAPACITY ACCORDING EN-13155



VACUUM SYSTEM AIR FLOW



TILTING EQUIPMENT



PUSHBUTTON CABLE LENGTH



MANUALLY TILTING EQUIPMENT



WIRELESS PUSHBUTTON



PNEUMATIC TILTING EQUIPMENT



LOAD CAPACITY ACCORDING EN-13155



MOTORIZED TILTING EQUIPMENT



EQUIPMENT SUPPORT SYSTEM



HYDRAULIC TILTING EQUIPMENT



LIFTING CRANE USABLE ROTATION



ROTATION EQUIPMENT